

Room Legend

- 1. Vestibule (130 sf)
- 2. Gathering Space (3690 sf)
- 3. Coat Storage (32 sf)
- 4. Gift Shop (56 sf)
- 5. Women's Restroom (new 290 sf/existing 160 sf)
-6 fixtures/3 existing fixtures
- 6. Men's Restroom (new 290 sf/existing 152 sf)
-6 fixtures/3 existing fixtures
- 7. Family Restroom (1 fixture, 131 sf)
- 8. Extended Storage (192 sf)
- 9. Extended Administration (328 sf)
- 10. Sacristy Storage (210 sf)
- 11. Bridal / Family Room (210sf)
- 12. Electrical Room (125 sf)
- 13. Table/Chair, Altar Society, and Knights of Columbus Storage (1498 sf)
- 14. Youth Group/Meeting Room (1170 sf)
- 15. Trash/Delivery (350 sf)
- 16. Kitchen (1220 sf) Kitchen Service/Bar (170 sf)
- 17. Storage (175 sf)
- 18. Stage (488 sf)
- 19. Parish Hall (6076 sf)
-450 seats shown with aisle, capacity for 500 seats
- 20. Extra Office (170 sf)
- 21. Library (516 sf)
- 22. DRE Office (185 sf)
- 23. Remodeled Classroom (582 sf - 965 sf)
- 24. Knights of Columbus / Meeting Room (700 sf)
- 25. Existing Boiler Room (386 sf)
- 26. Storage (176 sf)

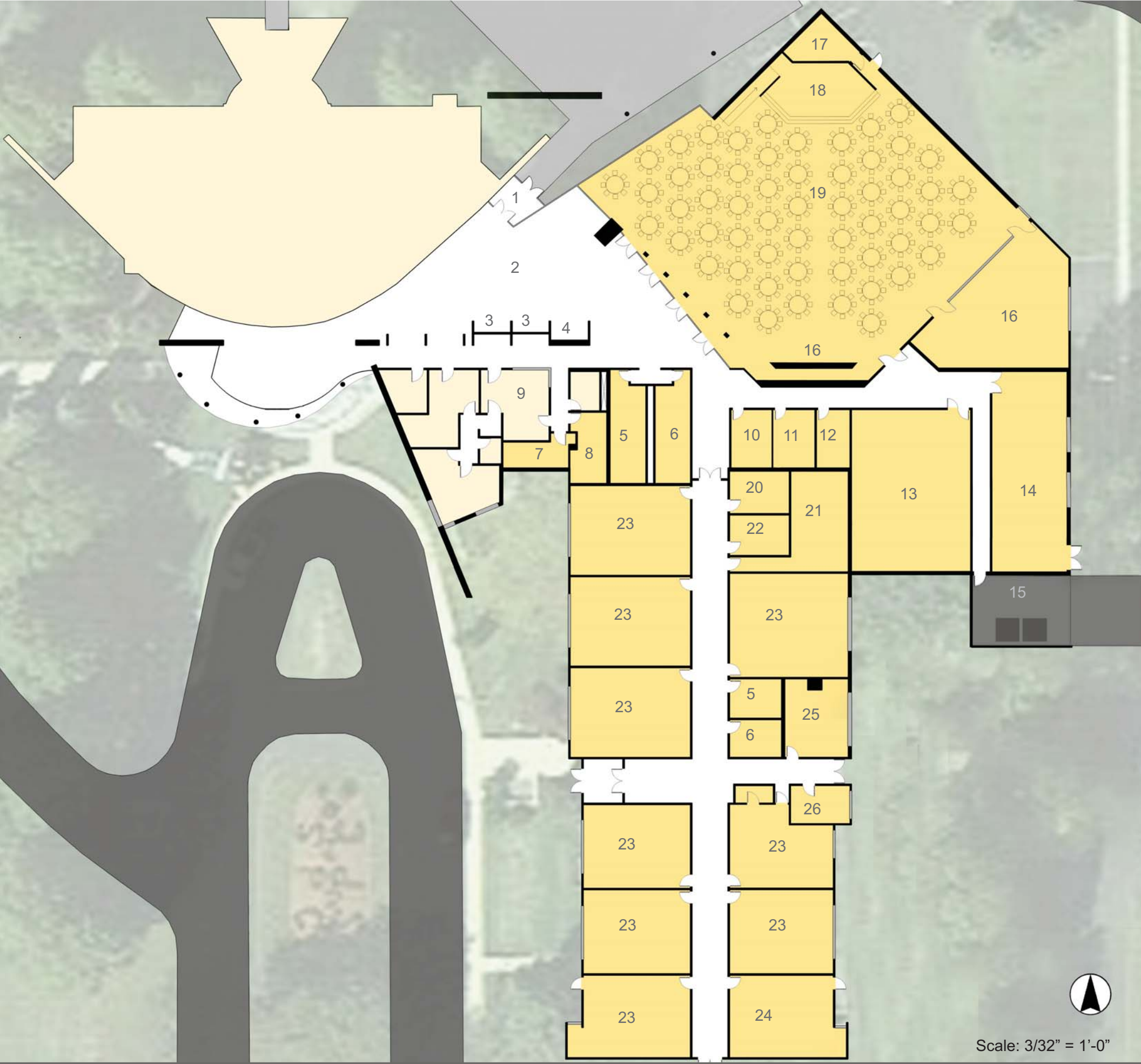

St Peter Catholic Church

parish hall floor plan